

5.28

Figure 5.28 The Millgate project: broadsheet.

Figure 5.29 The Millgate project: broadsheet.

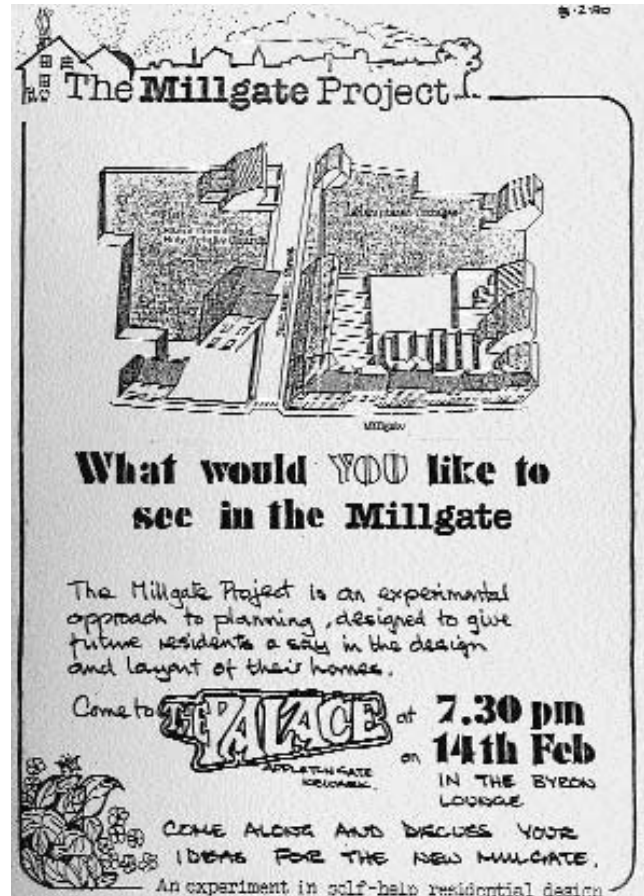

5.29

family types, while not statistically representative, nevertheless could be described as balanced. This was the group given the task of forming a community.

The group met in a room close to the site to introduce themselves, to meet the design team and to participate in the arrangements for additional design meetings (Figure 5.27). At the first meeting it was decided to produce a weekly broadsheet listing the forthcoming activities and the latest news about

the project (Figures 5.28 and 5.29). The second meeting was a walk about in the town conducted by architects from the local authority. The task of the architects was to try to show to the group features of Newark which make it so special and, in particular, to look in detail at the visual context of the streets surrounding the site. After these preliminary meetings aimed at building group confidence and solidarity the first design session took place. A model of the site outline was presented to the



Figure 5.30 The Millgate project: working round the model.

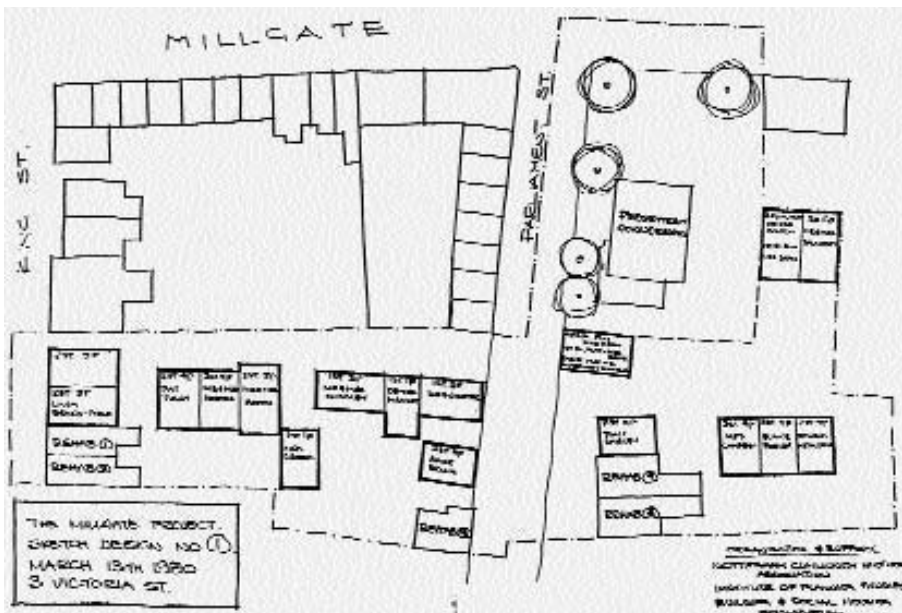

Figure 5.31 The Millgate project: sketch plan.